

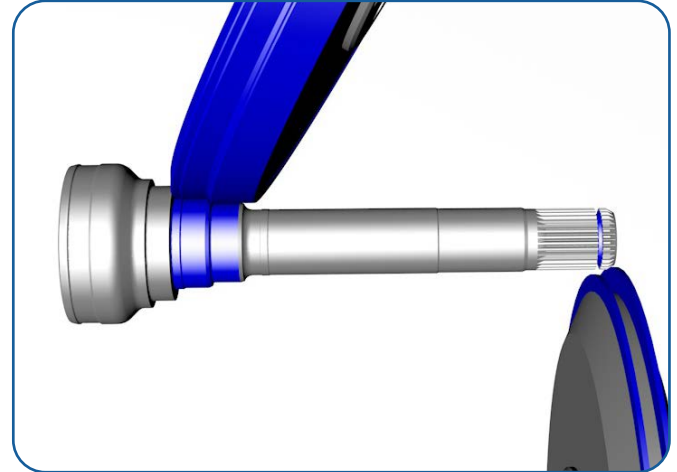

YOUR cylindrical grinding machine manufacturer

DRIVE SHAFT

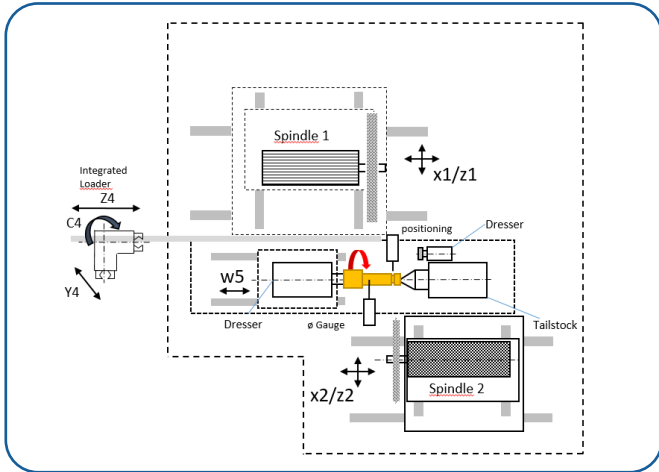

Complete CBN

- Machining of **joint pins**
- **Simultaneous** machining of **2** sides with **2** grinding wheels
- **Diameters, plane surfaces, end faces, radii and grooves**
- **Complete** grinding of the shaft in just **1 clamping setup** with **CBN** grinding wheels
- Cycle time **28.5'' = 0.48 min. = 2,577 parts / day** at **80% capacity** utilization in **3-shift operation**
- Axes with **linear drive**

